

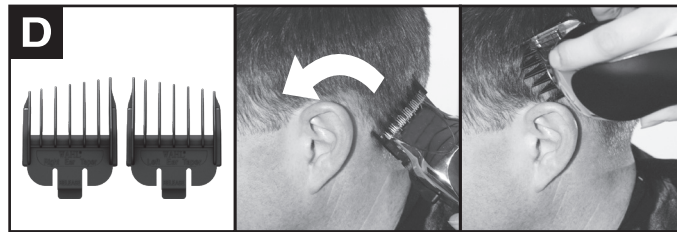

25 mm

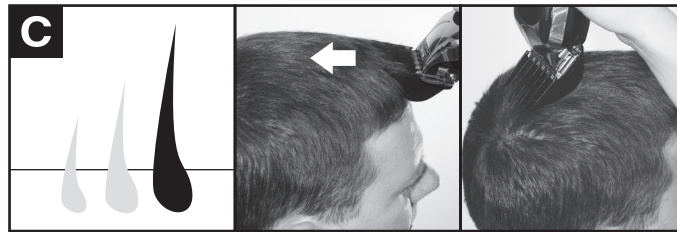

3 mm

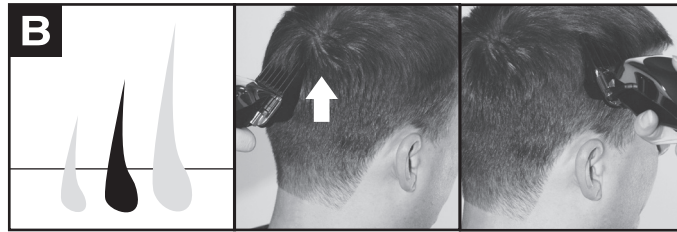
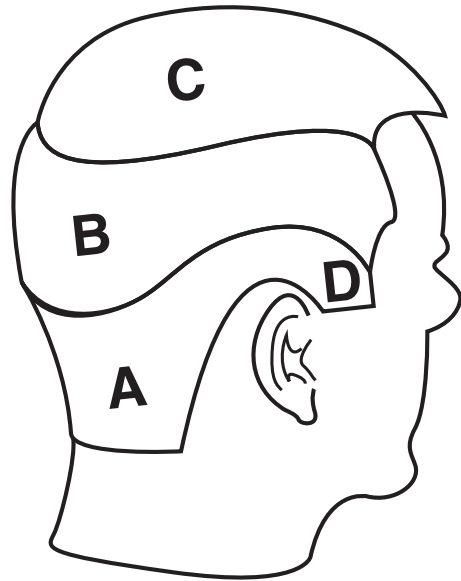

**1395 CORDED
PRODUCT GUIDE**

part no: 1395.2120

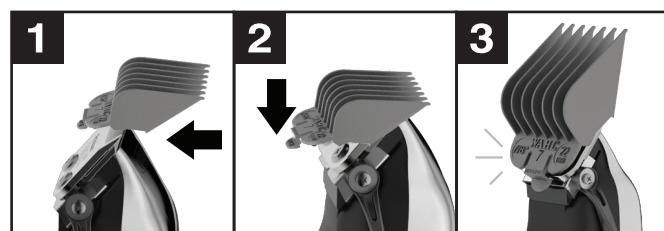
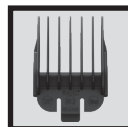
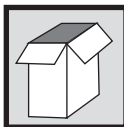

WAHL CLIPPER CORPORATION
World Headquarters
P.O. Box 578, Sterling, IL 61081

Wahl (UK) Limited
Sterling House, Clipper Close
Ramsgate, Kent CT12 5GG

Wahl Japan
K Building 8F
1-32-11 Yoyogi,
Shibuya-Ku, Tokyo 151-0053, Japan

Wahl Hungária Kft
H-9200 Mosonmagyaróvár
Barátság u.6.
Hungary

Wahl Australia PTY LTD
PO Box 456
Acacia Ridge QLD 4110,
Australia

Wahl International Consumer Group B.V.
Engelenburgstraat 36
7391 AM Twello,
The Netherlands

Wahl NZ Limited
PO Box 38 323
Wellington Mail Centre
Lower Hutt 5045, New Zealand

Wahl Spain
Fernando Giner de los Ríos 12
46910 Sedavi
Valencia, Spain

Wahl Clipper Brasil
Rodovia Geraldo Scavone,
2300 UC 45, Pedregulho,
Jacarei - SP. CEP: 12305-490

Wahl France SAS
1c rue Foch
67450 Mundolsheim
France

Wahl Argentina
Av. Alvarez Jonte 5655
Buenos Aires (C1407GPK), Argentina

WAHL Italia s.r.l.
Via Gobetti 52 - 1° piano
I-40129 Bologna (BO)
Italia

WAHL MEA FZCO
Dubai Airport Free Zone
P.O Box 371395, Dubai UAE

Представительство в РФ и РБ:
ООО УОЛЛ Рус
Ракетный бульвар, д. 16
129164 Москва / Russia (Россия)

Wahl Clipper (Pty) Ltd
PO Box 2918 Bedfordview,
Gauteng 2007 South Africa

Wahl India Grooming Products Pvt Ltd,
B-1002, 10TH Floor, B-Wing, Lotus Corporate Park,
Off Jay Coach Flyover,
Western Express Highway,
Goregaon-East, Mumbai 400-063

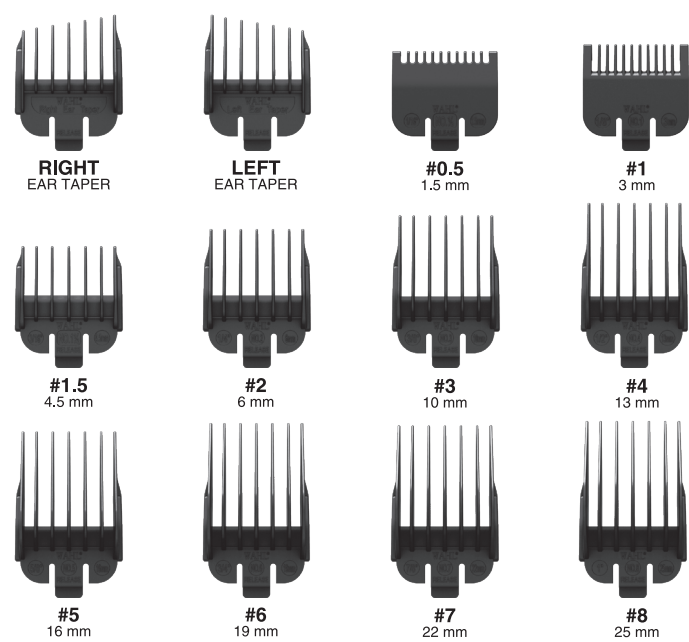
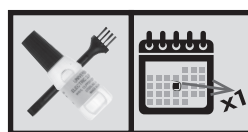

© 2020
Wahl® is a registered trademark
of Wahl Clipper Corporation
Revision 4/20 V1
www.wahl-consumer.com